

WAT-01-L / WAT-01-XL Installation Instructions

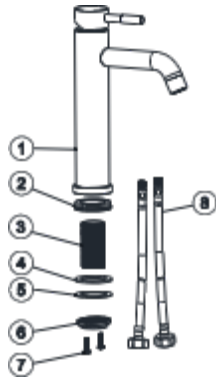

Parts List		
8.	Supply Lines Hot/Cold	2
7.	Screw	2
6.	Nut	1
5.	Washer	1
4.	Gasket	1
3.	M32 threaded pipe	1
2.	Gasket	1
1.	Body	1

You will need screwdriver, adjustable wrench adjustable pliers when Installation.

Installation Notes:

- ★ The hole of the basin should be $\varnothing 35$ mm, and the thickness of the sink should be between 30mm-32mm.

Installation Steps:

1. Connect the flexible supply lines (8) and thread the pipe body (3) on to the faucet body (1), and then insert the faucet through the hole in the basin.
2. Slide the rubber gasket (4) and the washer (5) onto the threaded pipe body underside.
3. Screw the nut (6) onto the pipe (3) and then tighten it.
4. Screw the screws (7) onto the nut (6) and then tighten it.
5. Wrap plumber's tape around the threads on the water taps.
6. Connect and tighten the supply lines (8).
7. Check for leaks by running and tighten if necessary.

